

The strength of innovation at CaPlast remains unchecked

Focus on cost reduction in crafts and trade



Energy efficiency remains an on-going theme

In particular, the enduring renaissance of wooden houses continues to provide a strong incentive for maintaining the familiar tight innovation cycles at CaPlast. Wooden houses, be they timber-frame or solid wood constructions, provide a comfortable living environment and offer almost unlimited design possibilities. Our protective façades and roofing membranes support excellent physical and ecological building characteristics, because one thing is clear with the current focus on sustainability: only **those products which are energy-saving and durable are going to form part of the future.**

Energy-efficient building is more than just a trend. It remains an on-going issue for reasons of climate protection, resource conservation and economy. High-quality diffusion permeable, windproof and waterproof, UV-resistant façade membranes from CaPlast protect insulation from moisture ingress over its entire lifespan. CaPlast system solutions for roofs and walls are optimised for a wide variety of insulation materials.

Economical and easy to work with

For many years, CaPlast has provided the full range of high-quality and durable building protection materials from the roll. The development work of the past months has therefore focussed on not only improved functionality but also, in particular, on simpler and more cost-effective working. We are proud to announce a world first: **CaPlur DaWa, a sarking and façade membrane for roofs and walls that can be used on both sides.**

CaPlast is also offering a versatile new accessory product that makes the worker's life a lot easier: **transparent and non-yellowing tape, CaTape Cameleon**, for easy seam inspection and almost invisible repairs. You can thus see that the construction sector of the business remains true to its goals and is developing products aligned exclusively to the needs of customers, in terms of function, comfort and economic value.

Moreover, thanks to you, we remain one of the leading specialists for individual coatings, composites and finishing. We look forward to talking with you!

CaPlur DaWa, a world first: dual membrane usable on both sides, for roofs and walls

More area per hour - the versatile and easy-to-work rolled product, CaPlur DaWa, saves valuable time on the construction site and thus also reduces storage costs for the trade and crafts. CaPlast is the world's first manufacturer to develop a **diffusion-permeable membrane that can be used on both sides**, wherein the various functions are indicated by different colours. The black side with increased UV-protection is ideally suited to façades having an open joint fraction of up to 40%. The grey side for flat sloping sub-roofs, attenuates the effect of reflected sunlight and heats up less - a boon when working on the roof. **A special plus for the transition from roof to façade:** the roof surface membrane is simply welded to the façade membrane and is thus immediately windproof and watertight. CaPlur DaWa is designed specifically for use in flat, sloping sub-roofs, dormer cheeks, pent roofs and façades with open joints of up to 5 cm.

The key points for CaPlur DaWa

- Polyester nonwoven, coated both sides with highly diffusion permeable TPU
- Façade: black coating with increased UV protection
- Roof: grey coating for attenuated sunlight reflection and low temperature rise
- Windproof and watertight
- Weldable seams
- Easy working by welding of the membranes at the transition from the roof into the façade

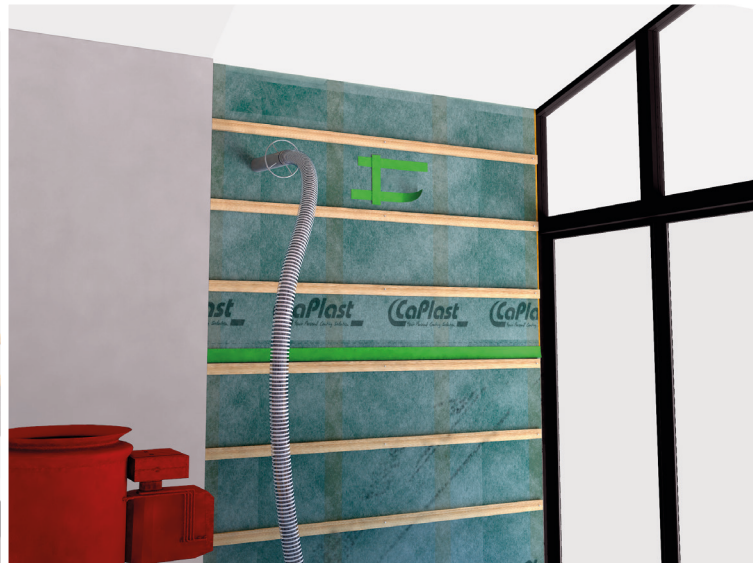
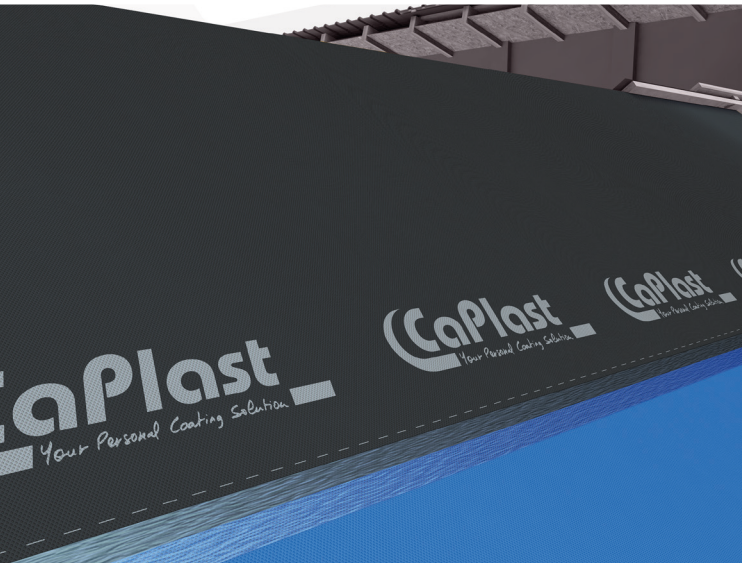

Innovation: permanently transparent adhesive tape for roof membranes CaTape Cameleon for easy visible seam inspection

Guaranteed to remain leaktight! Seams are a critical factor, in particular for vapour barriers, underlay and sarking membranes, as well as for façade membranes. During repair work and overlap bonding of vapour barriers and underlay membranes, the innovative transparent adhesive tape, CaTape Cameleon, now provides assurance that no moisture or damp can penetrate through the seam. The permanently transparent and non-yellowing material matches with any surface and enables simple visual seam inspection on the roof.

The key points for CaTape Cameleon

- Almost invisible adhesive repair tape
- Almost invisible overlap bonding of vapour barriers and underlay membranes
- For simple seam inspection
- Matches any surface
- Permanently transparent and non-yellowing
- Permanent outdoor weathering capacity

Key product CaTop XL Sun: Sarking and underlay for long-lasting outdoor weathering

Keeps out the wind and weather! When planning renovations and new builds, it must be ensured from the start of the construction work that neither moisture nor damp can penetrate the insulation or the construction. That guarantee is provided here by CaTop XL Sun sarking and underlay membranes made from polyurethane coated nonwoven PES materials, available with or without self adhesive strips.

These innovative sarking and/or underlay membranes maintain their outdoor weathering condition for up to one year and can provide a makeshift roof for up to 12 weeks, **or for up to a year with a matched CaPlast system.** In addition, through its approved sealing against driving rain, this premium product demonstrates extremely high abrasion and scratch resistance, oil and solvent resistance, as well as its sealing against wind and water.

The key points for CaTop XL Sun

- Extreme outdoor weathering capacity
- Approved sealing against driving rain
- Extremely high levels of resistance to abrasion and scratches
- Impervious to wind, water and driving rain
- Secure laying and easy handling
- Resistant to oil and tensile

Key product CaVap HP 5: Vapour barrier for insulation materials used in injection procedures

Also holds under pressure! When injecting insulating materials, the vapour barriers are exposed to high loads and must therefore not only be water vapour resistance but also, in particular, tear-resistant. The CaVap HP 5 vapour barrier, made from highly tear-resistant polyolefin coated PP nonwoven material, has an s_d value of 5 metres ($s_d \geq 5$ m).

CaVap HP 5 is also used for unventilated, diffusion permeable, wall and roof constructions in timber frame buildings, and generally for new builds and renovations. The reinforced nonwoven material has excellent inherent stability. Because of the translucent material, the rafters remain visible and the uniformity of the blown insulating material can be easily controlled.

The key points for CaVap HP 5

- Multi-use vapour barrier $s_d \geq 5$ m
- Good inherent stability through reinforced non-woven fibre
- Translucent (rafters are visible)
- Very high anti-tear values
- Easy and secure working
- Alkali resistant