

Instructions for roof renovation

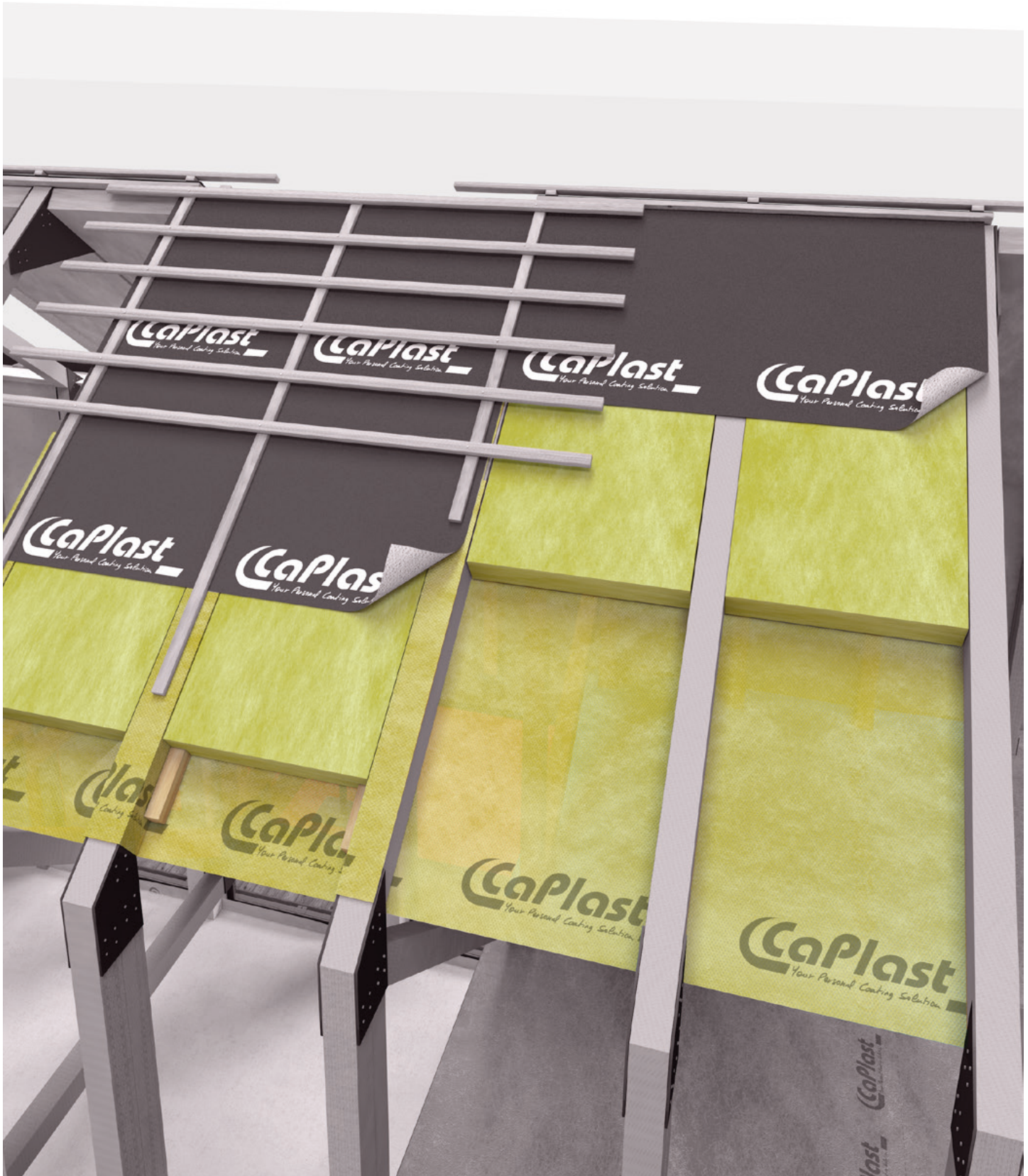

Instructions for roof renovation

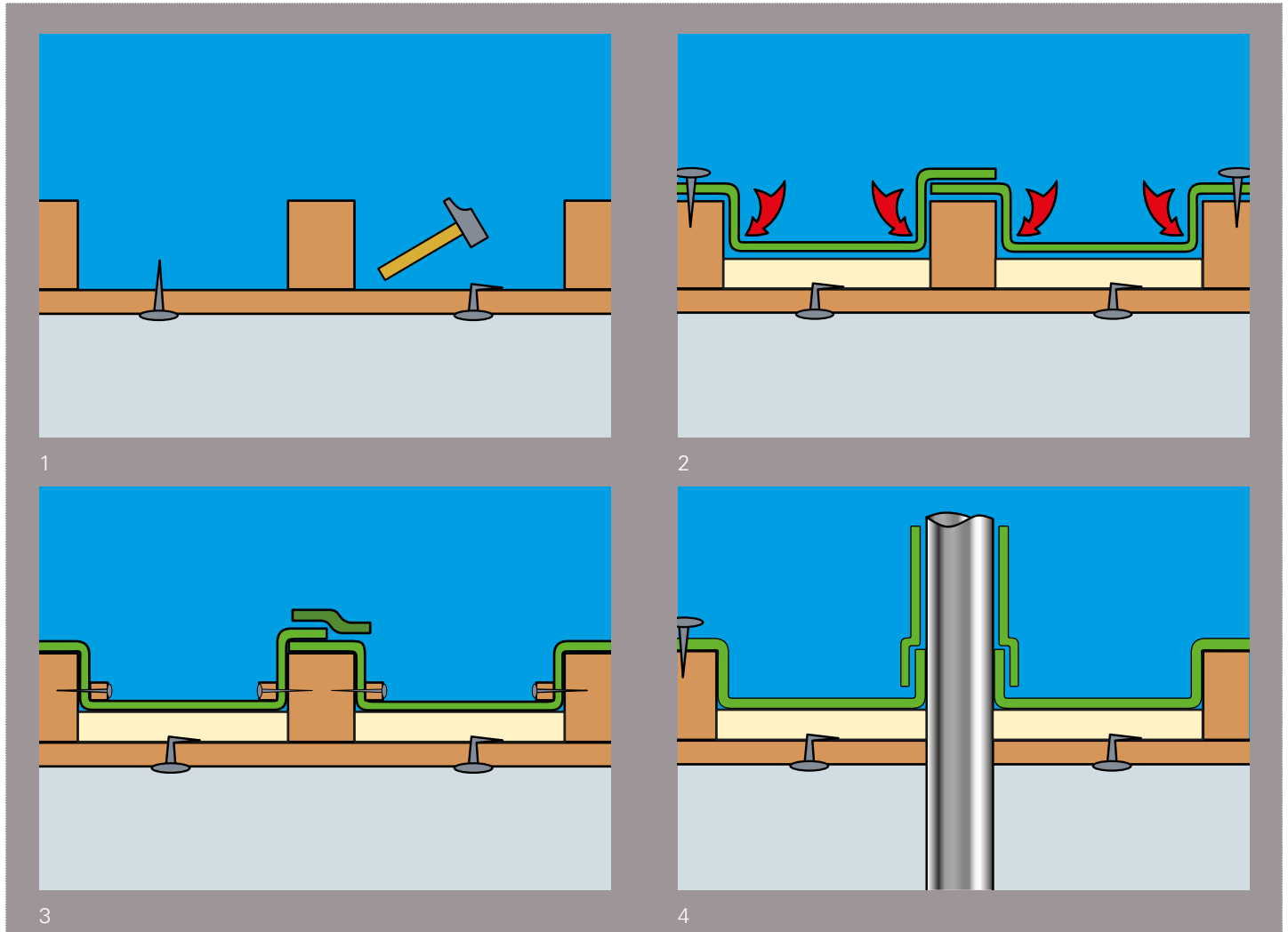

INSTRUCTIONS FOR USE OF CAVAP RENOVA, ECO RENOVA AND CAVAP 2

- 1 After lifting up the roof covering, free the space (between the timber frames) which is to be renovated from dirt and rubbish such as left over film etc.
Where appropriate, knock any protruding sharp or pointed objects (screws, sheeting etc.) into the surface.
- 2 Using a fleece mat or insulation strips, cover the remaining tips, corners and edges so that they cannot damage the vapour barrier. Lay the vapour barrier lengthways or crossways to the rafters.
- 3 In a way which makes it airtight and windproof, mount the vapour barrier at the gableboard onto the rafters using appropriate fasteners and in accordance with the technical rules, fasten at the base on both sides of the rafter using a batten. Proceed partition by partition. With the self-adhesive variant, we recommend that you cut into the masking tape before placing the reinforcement batten in this area. Afterwards loosen the masking tape, in each case from both sides towards the batten.
- 4 For CaVap products with an integrated self-adhesive attachment, the self-adhesive region acts as an assembly aid. Overlaps and misalignments are sealed using CaTape UV or CaTape Uni. Using CaTape UV or CaTape Uni, penetrations are to be integrated into the vapour barrier level by overlapping in a scale-like fashion so that they are airtight and impervious to moisture.

On no account can the vapour barrier be seen as a cover or equipment that forms the function of a cover, i.e. something to protect from the impact of rain. The vapour barrier is to be protected from the impact of weathering and covered straight away.

The markings on the membrane are guidance lines and are not an exact measurement. The processing temperature should not fall below + 5 °C. During work and implementation, observe the latest versions of the relevant standards, technical regulations, German Energy conservation regulation (EnEV) requirements and other applicable specifications. All details are provided to the best of our knowledge and belief. No warranty may be inferred.