

# CaFloor EB 1500



**Certification Number - P 5149 / 830 / 11-MPA BS**



# CaFloor EB 1500

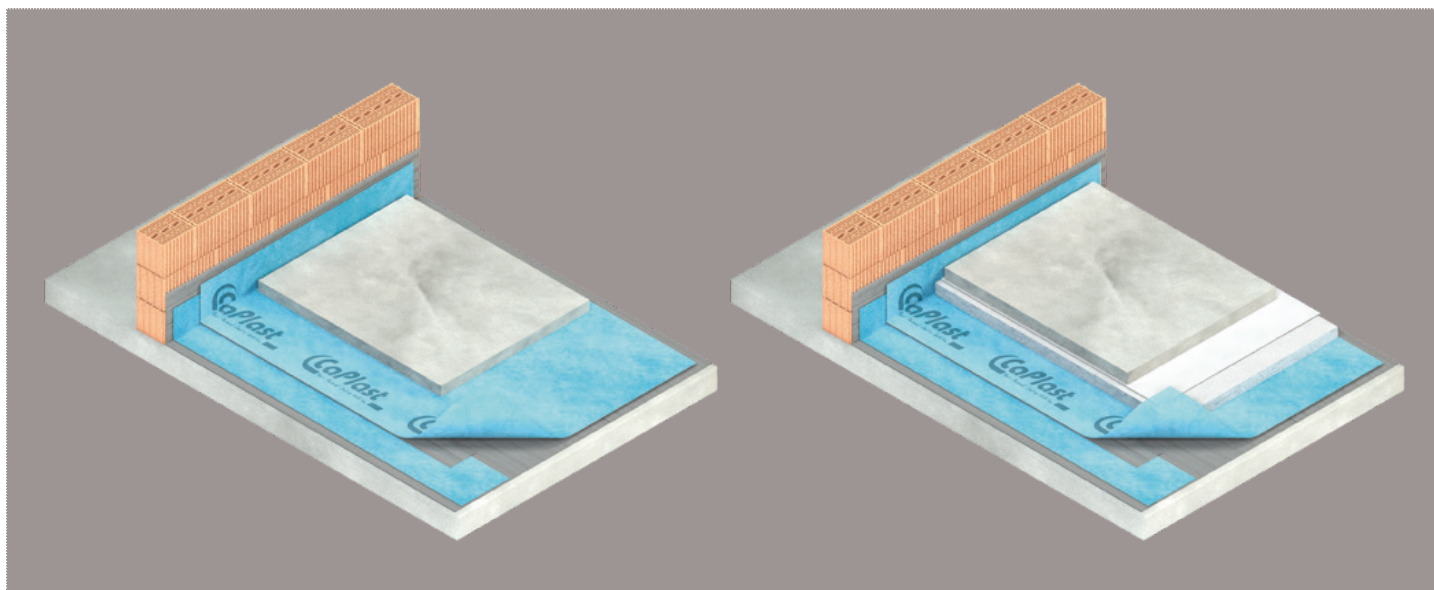

CaFloor EB 1500 is a high-grade moisture and radon barrier for floor slabs and concrete ceilings. The special multi-layer strip consists of a corrosion-resistant high-grade aluminium insert, which is fitted with a double-sided mat reinforcement. Optionally this membrane is available with or without self adhesive on the overlap area. The strip was specially developed as a vapour barrier for use on ground slabs which come into contact with soil in order to prevent rising damp (in accordance with DIN 18195-T4) or on floor slabs as a vapour barrier on structurally highly-stressed surfaces. It is also suitable and certified as a radon barrier. CaFloor EB 1500 effectively prevents the uncontrolled entry of moisture into the building. With its double sided matting, it is well protected against the roughness of the surface.

When working with the material it is necessary to observe the CaPlast laying information. Subject to technical modifications.

## FIELDS OF APPLICATION

- Soil contact ground slabs (DIN 18195-T4)
- Concrete ceilings against residual moisture in the hardening process
- Ceilings/floors as a vapour barrier
- As a radon barrier

## BENEFITS

- Highly flexible
- Resistant to perforation
- Alkali resistant
- Waterproof
- Radon tight
- Self-adhesive
- Free choice of floor covering

## TECHNICAL DATA

Weight (g/m <sup>2</sup> )	<b>200 ± 10%</b>
Building material	<b>E</b>
s <sub>d</sub> -value (m)	<b>&gt; 1500</b>
Tear resistance L/T (N/5 cm)	<b>200/160</b>
Elongation L/T (%)	<b>25/18</b>
Nail tear resistance L/T (N)	<b>50/50</b>
Watertightness	<b>Resistant</b>
Resistance to water penetration	<b>W 1</b>
Temperature resistance (°C)	<b>- 30 to + 80</b>
Roll width/Roll length (m)	<b>1.50/50</b>

Certification Number - P 5149/830/11-MPA BS

PROS E 04/19 EN

## LAYING METHOD

CaFloor EB 1500 is loosely laid on level floors which are free from ridges and dirt with a 10 cm overlap. The strip should be pulled up on ascending building elements, at least to the top edge of the finished floor. The long strokes and seams should be sealed using CaTape B 40 and also, in the case of heavy loads, CaTape Uni. When sealing ascending building elements in area that come into contact with the ground, CaFloor EB 1500 should be lifted up to the horizontal barrier of the inner and outer walls.